

Series 731-G Suction Diffuser

PRODUCT DESCRIPTION



Victaulic Series 731-G Suction Diffuser provides optimum flow conditions at the inlet side of the pump. Each suction diffuser is provided with a removable strainer and a fine mesh sleeve which acts as a start-up strainer. Pipe support bosses are provided to aid in proper alignment. For

convenience, bosses (tapped 1/2"/12,7 mm NPT) on either side are provided for pressure measurement. A plug is also provided to allow for easy draining of the system. Victaulic Series 731-G is rated at 300 PSI (2065 kPa) working pressure.

⚠ WARNING

Always depressurize and drain system before disassembly. Failure to do so could result in serious personal injury, property damage, joint leakage or joint separation.

ANSI Dimensions – Page 1
DIN Dimensions – Page 3
JIS Dimensions – Page 5

ANSI DIMENSIONS

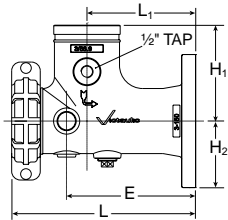

3" – 6" Sizes

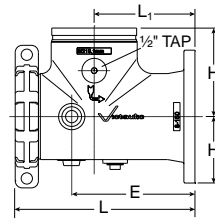
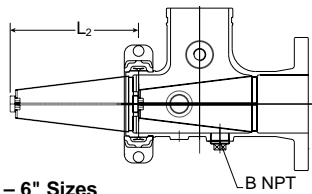

8" – 16" Sizes

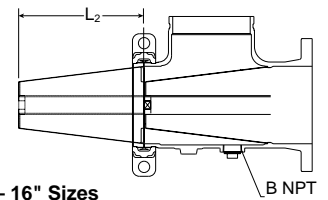

Series 731-G with ANSI Class 150 Flange

System Side Grvd.	SIZE	Pump Side Flgd. ANSI CLASS 150	Dimensions Inches/millimeters						Aprx. Wgt. Each Lbs./kg.	
			L	L ₁	L ₂ *	H ₁	H ₂	B NPT		E
3	2	2	10.63	6.30	7.05	5.51	3.00	1	7.48	21.7
	2 1/2	2 1/2	10.63	6.30	7.05	5.51	3.50	1	7.48	21.7
	3	3	10.63	6.30	7.05	5.51	3.74	1	7.48	21.7
	4	4	12.48	7.36	8.70	6.50	3.50	1	8.74	35.4
4	2 1/2	2 1/2	12.48	7.36	8.70	6.50	3.74	1	8.74	35.4
	3	3	12.48	7.36	8.70	6.50	3.50	1	8.74	35.4
	4	4	12.48	7.36	8.70	6.50	4.50	1	8.74	35.4
5	3	3	14.29	8.39	9.88	7.52	4.51	1 1/4	9.84	51.9
	4	4	14.29	8.39	9.88	7.52	4.92	1 1/4	9.84	51.9
	5	5	14.29	8.39	9.88	7.52	4.25	1 1/4	9.84	51.9
	6	6	15.51	9.02	10.75	7.99	4.51	1 1/4	10.98	68.2
6	4	4	15.51	9.02	10.75	7.99	4.92	1 1/4	10.98	68.2
	5	5	15.51	9.02	10.75	7.99	4.25	1 1/4	10.98	68.2
	6	6	15.51	9.02	10.75	7.99	5.49	1 1/4	10.98	68.2

*See minimum clearance requirement table on page 7.

VICTAULIC® IS AN ISO 9001 CERTIFIED COMPANY

<p>Victaulic Company of America Phone: 1-800-PICK-VIC (1-800-742-5842) Fax: 610-250-8817 e-mail: pickvic@victaulic.com</p>	<p>Victaulic Company of Canada Phone: 416-675-5575 Fax: 416-675-5565 e-mail: viccanada@victaulic.com</p>	<p>Victaulic Europe Phone: 32-9-381-1500 Fax: 32-9-380-4438 e-mail: viceuro@victaulic.be</p>	<p>Victaulic America Latina Phone: 610-559-3300 Fax: 610-559-3608 e-mail: vical@victaulic.com</p>	<p>Victaulic Asia Pacific Phone: 65-235-3035 Fax: 65-235-0535 e-mail: vicap@victaulic.com</p>
---	---	---	--	--

ANSI DIMENSIONS

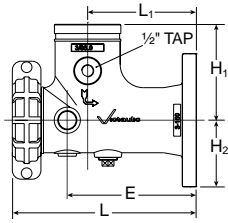

3" – 6" Sizes

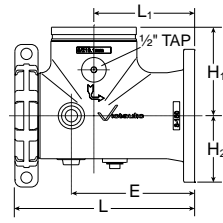
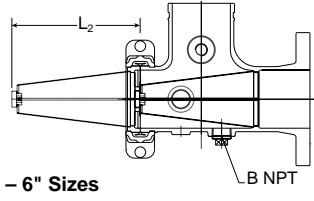

8" – 16" Sizes

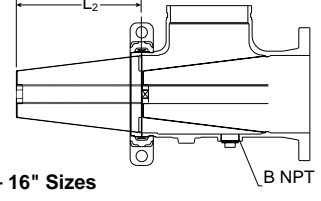

Series 731-G with ANSI Class 150 Flange

SIZE		Pump Side Flgd. ANSI CLASS 150	Dimensions Inches/millimeters							Aprx. Wgt. Each Lbs./kg.
System Side Grvd.	×		L	L ₁	L ₂ *	H ₁	H ₂	B NPT	E	
Nominal Inches/Actual mm										
8 219,1	×	5 141,3	18.27 464	10.24 260	12.72 323	9.02 229	5.00 127,0	1¼ 31,8	12.52 318	120.6 54,7
	×	6 168,3	18.27 464	10.24 260	12.72 323	9.02 229	5.49 139,5	1¼ 31,8	12.52 318	120.6 54,7
	×	8 219,1	18.27 464	10.24 260	12.72 323	9.02 229	6.75 171,5	1¼ 31,8	12.52 318	120.6 54,7
10 273,0	×	6 168,3	22.11 561,5	12.40 315	15.67 398	10.98 279	5.50 139,7	1¼ 31,8	15.55 395	192.5 87,3
	×	8 219,1	22.11 561,5	12.40 315	15.67 398	10.98 279	6.75 171,5	1¼ 31,8	15.55 395	192.5 87,3
	×	10 273,0	22.11 561,5	12.40 315	15.67 398	10.98 279	7.99 203,0	1¼ 31,8	15.55 395	192.5 87,3
12 323,9	×	8 219,1	26.30 668	15.43 392	18.66 474	13.19 335	6.75 171,5	1¼ 31,8	18.58 472	290.4 131,7
	×	10 273,0	26.30 668	15.43 392	18.66 474	13.19 335	7.99 203,0	1¼ 31,8	18.58 472	290.4 131,7
	×	12 323,9	26.30 668	15.43 392	18.66 474	13.19 335	9.70 246,5	1¼ 31,8	18.58 472	290.4 131,7
14 355,6	×	10 273,0	28.62 727	16.14 410	20.94 532	14.37 365	7.99 203,0	1½ 38,1	21.25 540	332.2 150,7
	×	12 323,9	28.62 727	16.14 410	20.94 532	14.37 365	9.50 241,3	1½ 38,1	21.25 540	332.2 150,7
	×	14 355,6	28.62 727	16.14 410	20.94 532	14.37 365	10.50 266,7	1½ 38,1	21.25 540	332.2 150,7
16 406,4	×	12 323,9	33.03 839	19.57 497	25.31 643	15.87 403	9.50 241,3	1½ 38,1	25.16 639	398.2 180,6
	×	14 355,6	33.03 839	19.57 497	25.31 643	15.87 403	10.50 266,7	1½ 38,1	25.16 639	398.2 180,6
	×	16 406,4	33.03 839	19.57 497	25.31 643	15.87 403	11.75 298,5	1½ 38,1	25.16 639	398.2 180,6

*See minimum clearance requirement table on page 7.

DIN DIMENSIONS

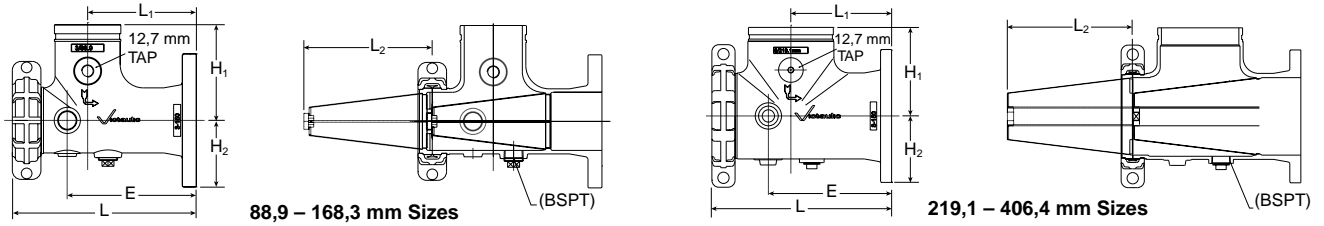

Series 731-G with PN10 Flange

SIZE		Pump Side Flgd. PN10	Dimensions millimeters/inches							Aprx. Wgt. Each kg/Lbs.
System Side Grvd.	Actual mm Nominal Inches		L	L ₁	L ₂ *	H ₁	H ₂	B BSPT	E	
88,9 3	X	DN50	270 10.63	160 6.30	179 7.05	140 5.51	82,5 3.25	25,4 1	190 7.48	9,8 21.7
	X	DN65	270 10.63	160 6.30	179 7.05	140 5.51	92,5 3.64	25,4 1	190 7.48	9,8 21.7
	X	DN80	270 10.63	160 6.30	179 7.05	140 5.51	100 3.94	25,4 1	190 7.48	9,8 21.7
114,3 4	X	DN65	317 12.48	187 7.36	221 8.70	165 6.50	92,5 3.64	25,4 1	222 8.74	16,1 35.4
	X	DN80	317 12.48	187 7.36	221 8.70	165 6.50	100 3.94	25,4 1	222 8.74	16,1 35.4
	X	DN100	317 12.48	187 7.36	221 8.70	165 6.50	110 4.33	25,4 1	222 8.74	16,1 35.4
141,3 5	X	DN80	363 14.29	213 8.39	251 9.88	191 7.52	110 4.33	31,8 1¼	250 9.84	23,5 51.9
	X	DN100	363 14.29	213 8.39	251 9.88	191 7.52	110 4.33	31,8 1¼	250 9.84	23,5 51.9
	X	DN125	363 14.29	213 8.39	251 9.88	191 7.52	125 4.92	31,8 1¼	250 9.84	23,5 51.9
168,3 6	X	DN100	394 15.51	229 9.02	273 10.75	203 7.99	110 4.33	31,8 1¼	279 10.98	30,9 68.2
	X	DN125	394 15.51	229 9.02	273 10.75	203 7.99	125 4.92	31,8 1¼	279 10.98	30,9 68.2
	X	DN150	394 15.51	229 9.02	273 10.75	203 7.99	142,5 5.61	31,8 1¼	279 10.98	30,9 68.2
219,1 8	X	DN125	464 18.27	260 10.24	323 12.72	229 9.02	125 4.92	31,8 1¼	318 12.52	54,7 120.6
	X	DN150	464 18.27	260 10.24	323 12.72	229 9.02	142,5 5.61	31,8 1¼	318 12.52	54,7 120.6
	X	DN200	464 18.27	260 10.24	323 12.72	229 9.02	170 6.69	31,8 1¼	318 12.52	54,7 120.6
273,0 10	X	DN150	561,5 22.11	315 12.40	398 15.67	279 10.98	142,5 5.61	31,8 1¼	395 15.55	87,3 192.5
	X	DN200	561,5 22.11	315 12.40	398 15.67	279 10.98	170 6.69	31,8 1¼	395 15.55	87,3 192.5
	X	DN250	561,5 22.11	315 12.40	398 15.67	279 10.98	197,5 7.78	31,8 1¼	395 15.55	87,3 192.5
323,9 12	X	DN200	668 26.30	392 15.48	474 18.66	335 13.19	170 6.69	31,8 1¼	472 18.58	131,7 290.4
	X	DN250	668 26.30	392 15.48	474 18.66	335 13.19	197,5 7.78	31,8 1¼	472 18.58	131,7 290.4
	X	DN300	668 26.30	392 15.48	474 18.66	335 13.19	222,5 8.76	31,8 1¼	472 18.58	131,7 290.4
355,6 14	X	DN250	727 28.62	410 16.14	532 20.94	365 14.37	202,5 7.97	38,1 1½	540 21.25	150,7 332.2
	X	DN300	727 28.62	410 16.14	532 20.94	365 14.37	222,5 8.76	38,1 1½	540 21.25	150,7 332.2
	X	DN350	727 28.62	410 16.14	532 20.94	365 14.37	252,5 9.94	38,1 1½	540 21.25	150,7 332.2
406,4 16	X	DN300	839 33.03	497 19.57	643 25.31	403 15.87	222,5 8.76	38,1 1½	639 25.16	180,6 398.2
	X	DN350	839 33.03	497 19.57	643 25.31	403 15.87	252,5 9.94	38,1 1½	639 25.16	180,6 398.2
	X	DN400	839 33.03	497 19.57	643 25.31	403 15.87	282,5 11.12	38,1 1½	639 25.16	180,6 398.2

*See minimum clearance requirement table on page 7.

DIN DIMENSIONS

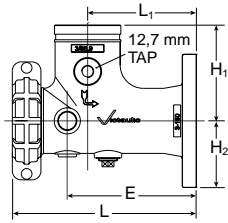

88,9 – 168,3 mm Sizes

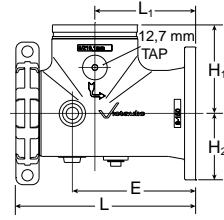
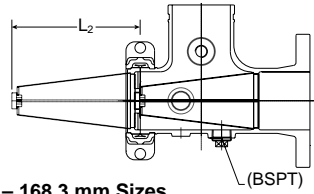

219,1 – 406,4 mm Sizes

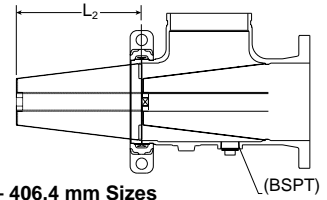

Series 731-G with PN16 Flange

System Side Grvd.	SIZE	Pump Side Flgd. PN16	Dimensions millimeters/inches							Aprx. Wgt. Each kg/Lbs.
			L	L ₁	L ₂ *	H ₁	H ₂	B BSPT	E	
88,9 3	X	DN50	270 10.63	160 6.30	179 7.05	140 5.51	82,5 3.25	25,4 1	190 7.48	9,8 21,7
	X	DN65	270 10.63	160 6.30	179 7.05	140 5.51	92,5 3.64	25,4 1	190 7.48	9,8 21,7
	X	DN80	270 10.63	160 6.30	179 7.05	140 5.51	100 3.94	25,4 1	190 7.48	9,8 21,7
114,3 4	X	DN65	317 12.48	187 7.36	221 8.70	165 6.50	92,5 3.64	25,4 1	222 8.74	16,1 35,4
	X	DN80	317 12.48	187 7.36	221 8.70	165 6.50	100 3.94	25,4 1	222 8.74	16,1 35,4
	X	DN100	317 12.48	187 7.36	221 8.70	165 6.50	110 4.33	25,4 1	222 8.74	16,1 35,4
141,3 5	X	DN80	363 14.29	213 8.39	251 9.88	191 7.52	110 4.33	31,8 1¼	250 9.84	23,5 51,9
	X	DN100	363 14.29	213 8.39	251 9.88	191 7.52	110 4.33	31,8 1¼	250 9.84	23,5 51,9
	X	DN125	363 14.29	213 8.39	251 9.88	191 7.52	125 4.92	31,8 1¼	250 9.84	23,5 51,9
168,3 6	X	DN100	394 15.51	229 9.02	273 10.75	203 7.99	110 4.33	31,8 1¼	279 10.98	30,9 68,2
	X	DN125	394 15.51	229 9.02	273 10.75	203 7.99	125 4.92	31,8 1¼	279 10.98	30,9 68,2
	X	DN150	394 15.51	229 9.02	273 10.75	203 7.99	142,5 5.61	31,8 1¼	279 10.98	30,9 68,2
219,1 8	X	DN125	464 18.27	260 10.24	323 12.72	229 9.02	125 4.92	31,8 1¼	318 12.52	54,7 120,6
	X	DN150	464 18.27	260 10.24	323 12.72	229 9.02	142,5 5.61	31,8 1¼	318 12.52	54,7 120,6
	X	DN200	464 18.27	260 10.24	323 12.72	229 9.02	170 6.69	31,8 1¼	318 12.52	54,7 120,6
273,0 10	X	DN150	561,5 22.11	315 12.40	398 15.67	279 10.98	142,5 5.61	31,8 1¼	395 15.55	87,3 192,5
	X	DN200	561,5 22.11	315 12.40	398 15.67	279 10.98	170 6.69	31,8 1¼	395 15.55	87,3 192,5
	X	DN250	561,5 22.11	315 12.40	398 15.67	279 10.98	202,5 7.97	31,8 1¼	395 15.55	87,3 192,5
323,9 12	X	DN200	668 26.30	392 15.48	474 18.66	335 13.19	170 6.69	31,8 1¼	472 18.58	131,7 290,4
	X	DN250	668 26.30	392 15.48	474 18.66	335 13.19	202,5 7.97	31,8 1¼	472 18.58	131,7 290,4
	X	DN300	668 26.30	392 15.48	474 18.66	335 13.19	230,0 9.06	31,8 1¼	472 18.58	131,7 290,4
355,6 14	X	DN250	727 28.62	410 16.14	532 20.94	365 14.37	212,5 8.37	38,1 1½	540 21.25	150,7 332,2
	X	DN300	727 28.62	410 16.14	532 20.94	365 14.37	230,0 9.06	38,1 1½	540 21.25	150,7 332,2
	X	DN350	727 28.62	410 16.14	532 20.94	365 14.37	260,0 10.25	38,1 1½	540 21.25	150,7 332,2
406,4 16	X	DN300	839 33.03	497 19.57	643 25.31	403 15.87	230,0 9.06	38,1 1½	639 25.16	180,6 398,2
	X	DN350	839 33.03	497 19.57	643 25.31	403 15.87	260,0 10.25	38,1 1½	639 25.16	180,6 398,2
	X	DN400	839 33.03	497 19.57	643 25.31	403 15.87	290,0 11.42	38,1 1½	639 25.16	180,6 398,2

*See minimum clearance requirement table on page 7.

JIS DIMENSIONS

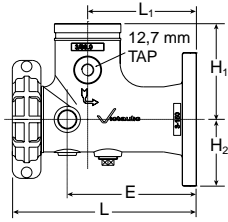

88,9 – 165,1 mm Sizes

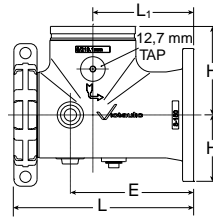
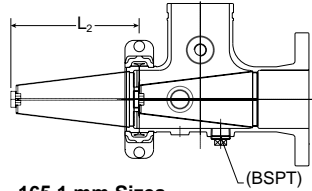

216,3 – 318,5 mm Sizes

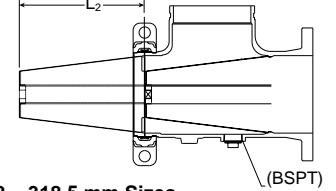

Series 731-G with JIS 10K Flange

SIZE		Dimensions millimeters/inches							Aprx. Wgt. Each kg/Lbs.
System Side Grvd.	Pump Side Flgd. 10K	L	L ₁	L ₂ *	H ₁	H ₂	B BSPT	E	
88,9	X 50A	270 10.63	160 6.30	179 7.05	140 5.51	77,5 3.05	25,4 1	190 7.48	9,8 21.7
	X 65A	270 10.63	160 6.30	179 7.05	140 5.51	87,5 3.44	25,4 1	190 7.48	9,8 21.7
	X 80A	270 10.63	160 6.30	179 7.05	140 5.51	92,5 3.64	25,4 1	190 7.48	9,8 21.7
114,3	X 65A	317 12.48	187 7.36	221 8.70	165 6.50	87,5 3.44	25,4 1	222 8.74	16,1 35.4
	X 80A	317 12.48	187 7.36	221 8.70	165 6.50	92,5 3.64	25,4 1	222 8.74	16,1 35.4
	X 100A	317 12.48	187 7.36	221 8.70	165 6.50	105 4.13	25,4 1	222 8.74	16,1 35.4
139,7	X 100A	363 14.29	213 8.39	251 9.88	191 7.52	105 4.13	31,8 1¼	250 9.84	23,5 51.9
	X 125A	363 14.29	213 8.39	251 9.88	191 7.52	125 4.92	31,8 1¼	250 9.84	23,5 51.9
165,1	X 100A	394 15.51	229 9.02	273 10.75	203 7.99	105 4.13	31,8 1¼	279 10.98	30,4 68.2
	X 125A	394 15.51	229 9.02	273 10.75	203 7.99	125 4.92	31,8 1¼	279 10.98	30,4 68.2
	X 150A	394 15.51	229 9.02	273 10.75	203 7.99	140 5.51	31,8 1¼	279 10.98	30,4 68.2
216,3	X 150A	464 18.27	260 10.24	323 12.72	229 9.02	140 5.51	31,8 1¼	318 12.52	54,7 120.6
	X 200A	464 18.27	260 10.24	323 12.72	229 9.02	165 6.50	31,8 1¼	318 12.52	54,7 120.6
267,4	X 200A	561,5 22.11	315 12.40	398 15.67	279 10.98	165 6.50	31,8 1¼	395 15.55	87,3 192.5
	X 250A	561,5 22.11	315 12.40	398 15.67	279 10.98	200 7.87	31,8 1¼	395 15.55	87,3 192.5
318,5	X 250A	668 26.30	392 15.48	474 18.66	335 13.19	200 7.87	31,8 1¼	472 18.58	131,7 290.4
	X 300A	668 26.30	392 15.48	474 18.66	335 13.19	222,5 8.78	31,8 1¼	472 18.58	131,7 290.4
406,4	X 300A	839 33.03	497 19.57	643 25.31	403 15.87	222,5 8.78	38,1 1½	639 25.16	180,6 398.2
	X 325A	839 33.03	497 19.57	643 25.31	403 15.87	222,5 8.78	38,1 1½	639 25.16	180,6 398.2
	X 400A	839 33.03	497 19.57	643 25.31	403 15.87	290,0 11.42	38,1 1½	639 25.16	180,6 398.2

*See minimum clearance requirement table on page 7.

JIS DIMENSIONS

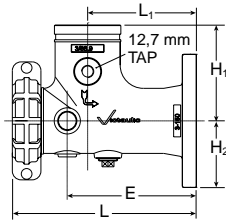

88,9 – 165,1 mm Sizes

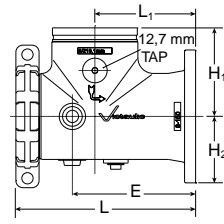
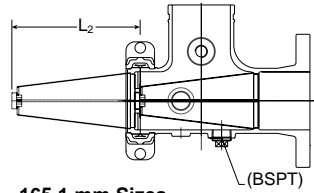

216,3 – 318,5 mm Sizes

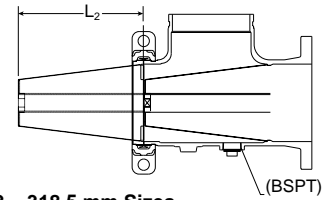

Series 731-G with JIS 20K Flange

SIZE		Dimensions millimeters/inches							Aprx. Wgt. Each kg/Lbs.
System Side Grvd.	Pump Side Flgd. 20K	L	L ₁	L ₂ *	H ₁	H ₂	B BSPT	E	
88,9	X 50A	270 10.63	160 6.30	179 7.05	140 5.51	77,5 3.05	25,4 1	190 7.48	9,8 21.7
	X 65A	270 10.63	160 6.30	179 7.05	140 5.51	87,5 3.44	25,4 1	190 7.48	9,8 21.7
	X 80A	270 10.63	160 6.30	179 7.05	140 5.51	100,0 3.94	25,4 1	190 7.48	9,8 21.7
	X 100A	317 12.48	187 7.36	221 8.70	165 6.50	87,5 3.44	25,4 1	222 8.74	16,1 35.4
114,3	X 65A	317 12.48	187 7.36	221 8.70	165 6.50	87,5 3.44	25,4 1	222 8.74	16,1 35.4
	X 80A	317 12.48	187 7.36	221 8.70	165 6.50	100,0 3.94	25,4 1	222 8.74	16,1 35.4
	X 100A	317 12.48	187 7.36	221 8.70	165 6.50	112,5 4.43	25,4 1	222 8.74	16,1 35.4
139,7	X 100A	363 14.29	213 8.39	251 9.88	191 7.52	112,5 4.43	31,8 1¼	250 9.84	23,5 51.9
	X 125A	363 14.29	213 8.39	251 9.88	191 7.52	135,0 5.82	31,8 1¼	250 9.84	23,5 51.9
	X 150A	394 15.51	229 9.02	273 10.75	203 7.99	112,5 4.43	31,8 1¼	279 10.98	30,4 68.2
165,1	X 100A	394 15.51	229 9.02	273 10.75	203 7.99	112,5 4.43	31,8 1¼	279 10.98	30,4 68.2
	X 125A	394 15.51	229 9.02	273 10.75	203 7.99	135,0 5.82	31,8 1¼	279 10.98	30,4 68.2
	X 150A	394 15.51	229 9.02	273 10.75	203 7.99	154 6.06	31,8 1¼	279 10.98	30,4 68.2
216,3	X 150A	464 18.27	260 10.24	323 12.72	229 9.02	152,5 6.00	31,8 1¼	318 12.52	54,7 120.6
	X 200A	464 18.27	260 10.24	323 12.72	229 9.02	175 6.89	31,8 1¼	318 12.52	54,7 120.6
267,4	X 200A	561,5 22.11	315 12.40	398 15.67	279 10.98	175 6.89	31,8 1¼	395 15.55	87,3 192.5
	X 250A	561,5 22.11	315 12.40	398 15.67	279 10.98	215 8.47	31,8 1¼	395 15.55	87,3 192.5
318,5	X 250A	668 26.30	392 15.48	474 18.66	335 13.19	215 8.47	31,8 1¼	472 18.58	131,7 290.4
	X 300A	668 26.30	392 15.48	474 18.66	335 13.19	240 9.95	31,8 1¼	472 18.58	131,7 290.4
406,4	X 300A	839 33.03	497 19.57	643 25.31	403 15.87	240 9.95	38,1 1½	639 25.16	180,6 398.2
	X 325A	839 33.03	497 19.57	643 25.31	403 15.87	270 10.63	38,1 1½	639 25.16	180,6 398.2
	X 400A	839 33.03	497 19.57	643 25.31	403 15.87	310 12.20	38,1 1½	639 25.16	180,6 398.2

*See minimum clearance requirement table on page 7.

ASSEMBLY CLEARANCE

The recommended access requirements are listed in the following table. *NOTE: These recommended clearances are equal to the minimum clearance, plus 2" (51 mm).

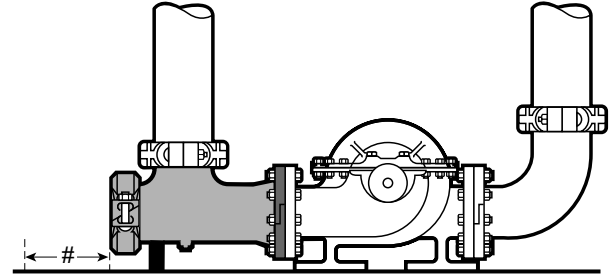

#Recommended Minimum Clearance Required to Remove Diffuser Basket Actual Inches/Actual mm					
Inlet Size	Clearance	Recommended Support Leg Pipe Diameter †	Inlet Size	Clearance	Recommended Support Leg Pipe Diameter †
3 88,9	9,00 230	1¼	8 219,1	15,00 381	2
4 114,3	11,00 279	1¼	267,4	457	2
139,7	305	2	10 273,0	18,00 457	2
5 141,3	12,00 305	2	318,5	533	2
165,1	300	2	12 323,9	21,00 533	2
6 168,3	13,00 330	2	14 355,6	23,00 584	2
216,3	381	2	16 406,4	27,00 686	2

† Based on Schedule 40 pipe diameter.

MATERIAL SPECIFICATIONS

Housing (body, coupling, end cap): Ductile iron conforming to ASTM A-395.

Coupling Gasket: (specify choice)*

Standard

Grade "E" EPDM

EPDM (Green color code). Temperature range -30°F to +230°F (-34°C to +110°C). Recommended for cold and hot water service within the specified temperature range plus a variety of dilute acids, oil-free air and many chemical services. UL classified in accordance with ANSI/NSF 61 for cold +86°F (+30°C) and hot +180°F (+82°C) potable water service. NOT RECOMMENDED FOR PETROLEUM SERVICES.

Optional - Special Order

Grade "T" nitrile

Nitrile (Orange color code). Temperature range -20°F to +180°F (-29°C to +82°C). Recommended for petroleum products, air with oil vapors, vegetable and mineral oils within the specified temperature range. Not recommended for hot water services over +150°F (+66°C) or for hot dry air over +140°F (+60°C).

*Services listed are General Service Recommendations only. It should be noted that there are services for which these gaskets are not recommended. Reference should always be made to the latest Victaulic Gasket Selection Guide for specific gasket service recommendations and for a listing of services which are not recommended.

Diffuser: Stainless steel, type 304, frame and perforated sheet with ⅝" (4 mm) # diameter holes.

#14" (355,6 mm) and 16" (406,4 mm) have ⅜" (4,8 mm) diameter holes.

Start-up Pre-filter: 20 mesh Stainless steel, type 304.

Bolts/Nuts: Heat treated carbon steel, track head conforming to physical properties of ASTM A-183 minimum tensile 110,000 PSI

Support: Boss for support. See table above for size. (Support not supplied).

PERFORMANCE DATA

Pressure loss values for flow of water at 60°F (+16°C) shown below.

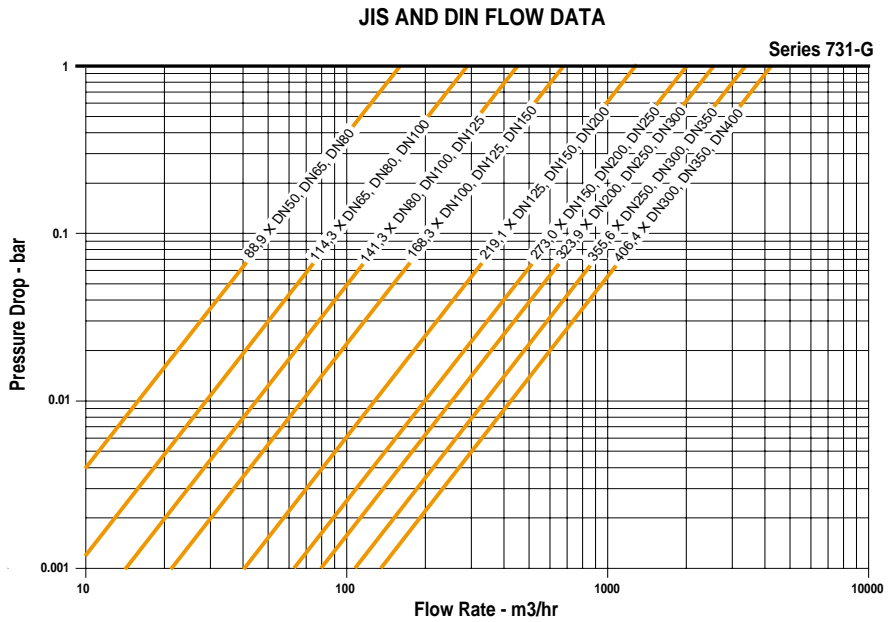
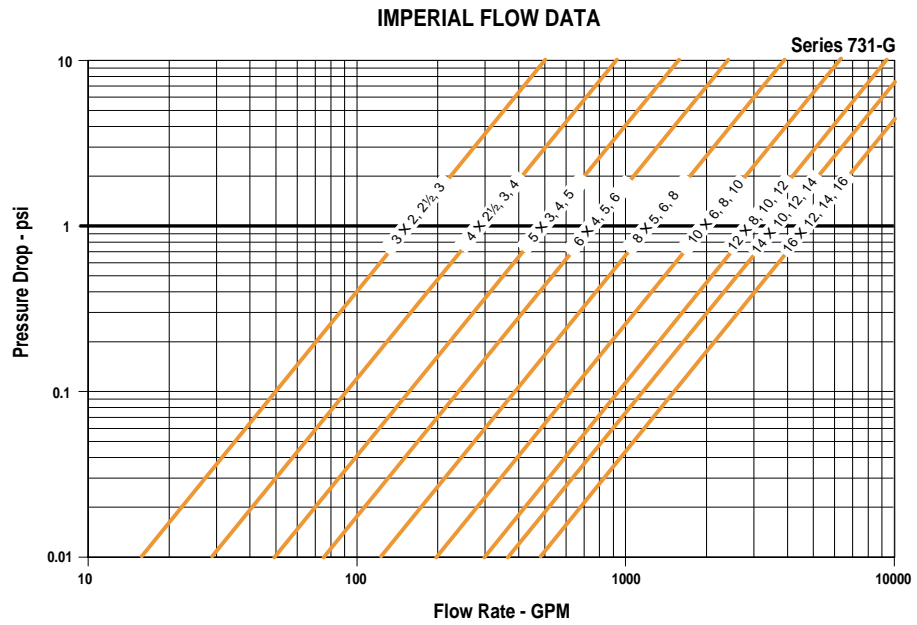

1 psi/1 bar equals C_v/K_v

All products shall be installed in accordance with current Victaulic installation/assembly instructions. Victaulic reserves the right to change product specifications, designs and standard equipment without notice and without incurring obligations.